

CONDOR



Introduction

Condor was founded in 2009, which covers 20,000 square meters and owns 150 staffs including 25 professional engineers. Condor is one professional manufacturer for gate valve, butterfly valve, check valve etc. Condor Valves can be used on city pipeline construction, drinking water, and fire protection area.

Since establishment, supplying the products with high quality and best service to the customers have been our core targets. Now the company has got ISO9001 certificates, and the products have been approved or listed by FM and UL. Through strict quality control and scientific production management, Condor is being on the way to be one famous brand in domestic and foreign market.

Flanged OS&Y gate valve



- Certificate: UL Listed / FM Approved
- Standard: UL 262 / AWWA C515
- Connection: Flanged as ASME B16.1
- Test: Factory hydro test 450 psi
- Temperature: 0°C to 100°C
- W. pressure: 300 psi
- Surface: Epoxy coating as Ral3000

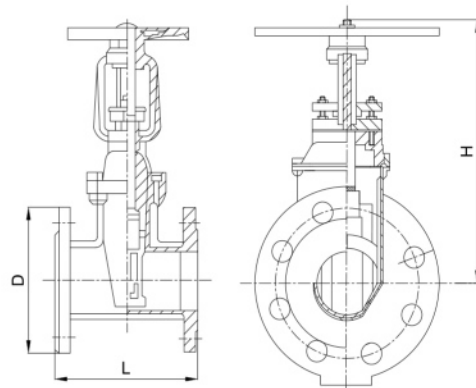

Main parts and material

Body	Ductile iron as A536, 65-45-12	Bonnet	Ductile iron as A536, 65-45-12
Resilient wedge disc	Ductile iron as A536, 65-45-12 + EPDM	Stem	SS304 / SS316 / SS420 / SS431
Yoke	Ductile iron as A536, 65-45-12	Handwheel	Ductile iron as A536, 65-45-12

Available size

Size			Dimension (mm)				Bolting (n x φd)	Ref. No.
Inch	DN	mm	L	H min	H max	D		
2"	50	60.3	178	348	400	152	4 x 3/4"	C501050
2-1/2"	65	73.0	190	373	440	178	4 x 3/4"	C501065
3"	80	88.9	203	408	490	191	4 x 3/4"	C501080
4"	100	114.3	229	471	573	229	8 x 3/4"	C501100
6"	150	168.3	267	601	755	279	8 x 7/8"	C501150
8"	200	219.1	292	774	975	343	8 x 7/8"	C501200
10"	250	273.0	330	939	1193	406	12 x 1"	C501250
12"	300	323.8	356	1065	1370	483	12 x 1"	C501300

Flanged OS&Y gate valve



- Certificate: UL Listed / FM Approved
- Standard: EN1171
- Connection: Flanged as BS EN 1092-2
- Test: Factory hydro test 24 bar
- Temperature: 0°C to 100°C
- W. pressure: PN 16/300Psi
- Surface: Epoxy coating as Ral3000

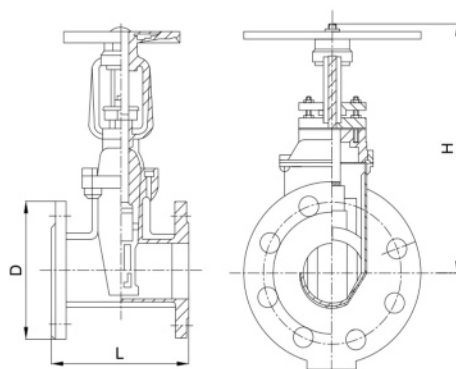

Main parts and material

Body	Ductile iron as EN-GJS-450-10	Bonnet	Ductile iron as EN-GJS-450-10
Resilient wedge disc	Ductile iron as EN-GJS-450-10 + EPDM	Stem	SS304 / SS316 / SS420 / SS431
Yoke	Ductile iron as EN-GJS-450-10	Handwheel	Ductile iron as EN-GJS-450-10

Available size

Size			Dimension (mm)				Bolting (n x φd)	Ref. No.
Inch	DN	mm	L	H min	H max	D		
2"	50	60.3	150	348	400	165	4 x 3/4"	F401050
2-1/2"	65	76.1	170	373	440	185	4 x 3/4"	F401065
3"	80	88.9	180	408	490	200	4 x 3/4"	F401080
4"	100	114.3	190	471	573	220	8 x 3/4"	F401100
6"	150	168.3	210	601	755	285	8 x 7/8"	F401150
8"	200	219.1	230	774	975	340	8 x 7/8"	F401200
10"	250	273.0	250	939	1193	405	12 x 1"	F401250
12"	300	323.9	270	1065	1370	460	12 x 1"	F401300

Grooved OS&Y gate valve



- Certificate: UL Listed / FM Approved
- Standard: UL 262 / AWWA C515
- Connection: Grooved as AWWA C606
- Test: Factory hydro test 450 psi
- Temperature: 0°C to 100°C
- W. pressure: 300 psi
- Surface: Epoxy coating as Ra13000

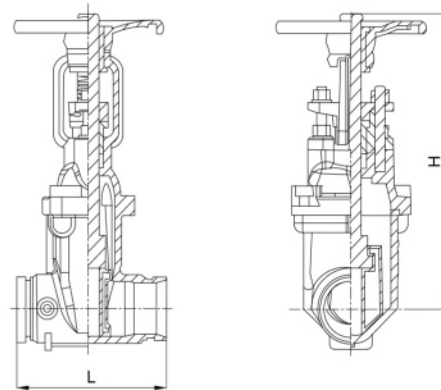

Main parts and material

Body	Ductile iron as A536, 65-45-12	Bonnet	Ductile iron as A536, 65-45-12
Resilient wedge disc	Ductile iron as A536, 65-45-12 + EPDM	Stem	SS304 / SS304 / SS420 / SS431
Yoke	Ductile iron as A536, 65-45-12	Handwheel	Ductile iron as A536, 65-45-12

Available size

Size			Dimension (mm)			Ref. No.
Inch	DN	mm	L	H min	H max	
2"	50	60.3	178	348	400	G100060
2-1/2"	65	73	190	373	440	G100073
3OD	65	76.1	190	373	440	G100076
3"	80	88.9	203	408	490	G100089
4"	100	114.3	229	471	573	G100114
6.5OD	150	165.1	267	601	755	G100165
6"	150	168.3	267	601	755	G100168
8"	200	219.1	292	774	975	G100219
10"	250	273	330	1029	1283	G100273
12"	300	323.8	356	1065	1370	G100324

Flanged NRS gate valve with post flange



- Certificate: Pending
- Standard: BS 5163
- Connection: Flanged as BS EN 1092-2
- Test: Factory hydro test 24 bar
- Temperature: 0°C to 100°C
- W. pressure: PN 16
- Surface: Epoxy coating as Ra13000

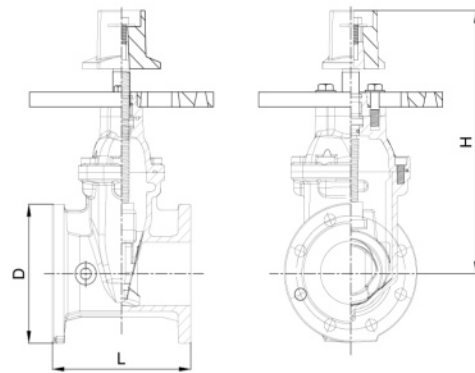

Main parts and material

Body	Ductile iron as EN-GJS-450-10	Bonnet	Ductile iron as EN-GJS-450-10
Resilient wedge disc	Ductile iron as EN-GJS-450-10 + EPDM	Stem	SS304 / SS316 / SS420 / SS431
Thrust washer	Brass as B124 C37000	Post flange	Ductile iron as EN-GJS-450-10

Available size

Size			Dimension (mm)			Bolting (n x φd)	Ref. No.
Inch	DN	mm	L	H	D		
4"	100	114.3	229	347	220	8 x φ19	F301100
5"	125	139.7	254	432	250	8 x φ19	F301125
6"	150	168.3	267	443	285	8 x φ23	F301150
8"	200	219.1	292	518	340	12 x φ23	F301200
10"	250	273.0	330	656	405	12 x φ28	F301250
12"	300	323.9	356	751	460	12 x φ28	F301300

Flanged NRS gate valve with post flange



- Certificate: Pending
- Standard: UL 262 / AWWA C515
- Connection: Flanged as ASME B16.1
- Test: Factory hydro test 450 psi
- Temperature: 0°C to 100°C
- W. pressure: 300 psi
- Surface: Epoxy coating as Ral3000

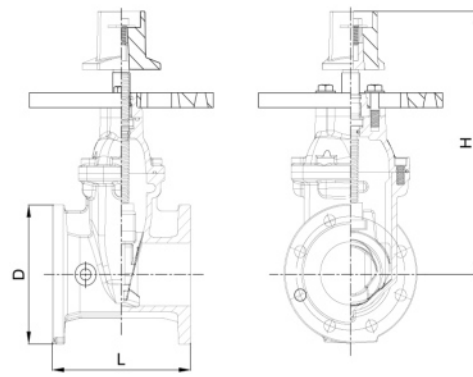

Main parts and material

Body	Ductile iron as A536, 65-45-12	Bonnet	Ductile iron as A536, 65-45-12
Resilient wedge disc	Ductile iron as A536, 65-45-12 + EPDM	Stem	SS304 / SS316 / SS420 / SS431
Thrust washer	Brass as B124 C37000	Post flange	Ductile iron as A536, 65-45-12

Available size

Size			Dimension (mm)			Bolting (n x φd)	Ref. No.
Inch	DN	mm	L	H	D		
4"	100	114.3	229	395	229	8 x 3/4"	C502100
5"	125	141.3	254	432	254	8 x 7/8"	C502125
6"	150	168.3	267	475	279	8 x 7/8"	C502150
8"	200	219.1	292	585	343	8 x 7/8"	C502200
10"	250	273.0	330	656	406	12 x 1"	C502250
12"	300	323.8	356	751	483	12 x 1"	C502300

Flanged NRS gate valve



- Certificate: PENDING
- Standard: BS 5163
- Connection: Flanged as BS EN 1092-2
- Test: Factory hydro test 24 bar
- Temperature: 0°C to 100°C
- W. pressure: PN 16/300Psi
- Surface: Epoxy coating as Ral3000

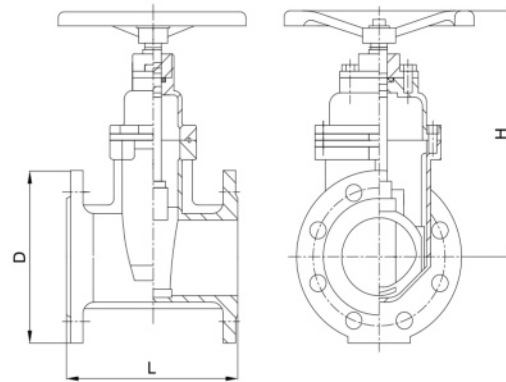

Main parts and material

Body	Ductile iron as EN-GJS-450-10	Bonnet	Ductile iron as EN-GJS-450-10
Resilient wedge disc	Ductile iron as EN-GJS-450-10 + EPDM	Stem	SS304 / SS316 / SS420 / SS431
Thrust washer	Brass as B124 C37000	Handwheel	Ductile iron as EN-GJS-450-10

Available size

Size			Dimension (mm)			Bolting (n x φd)	Ref. No.
Inch	DN	mm	L	H	D		
2"	50	60.3	178	241	165	4 x φ19	F302050
2-1/2"	65	76.1	190	255	185	4 x φ19	F302065
3"	80	88.9	203	304	200	8 x φ19	F302080
4"	100	114.3	229	337	220	8 x φ19	F302100
5"	125	139.7	254	404	250	8 x φ19	F302125
6"	150	168.3	267	436	285	8 x φ23	F302150
8"	200	219.1	292	443	340	12 x φ23	F302200
10"	250	273.0	330	641	405	12 x φ28	F302250
12"	300	323.9	356	743	460	12 x φ28	F302300

Grooved NRS gate valve



- Certificate: Pending
- Standard: UL 262 / AWWA C515
- Connection: Flanged as ASME B16.1
- Test: Factory hydro test 450 psi
- Temperature: 0°C to 100°C
- W. pressure: 300 psi
- Surface: Epoxy coating as Ra13000

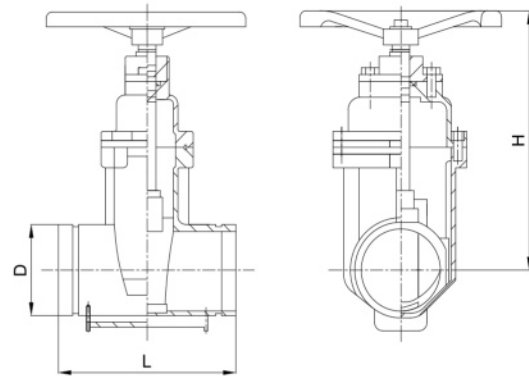

Main parts and material

Body	Ductile iron as A536, 65-45-12	Bonnet	Ductile iron as A536, 65-45-12
Resilient wedge disc	Ductile iron as A536, 65-45-12 + EPDM	Stem	SS304 / SS316 / SS420 / SS431
Thrust washer	Brass as B124 C37000	Handwheel	Ductile iron as A536, 65-45-12

Available size

Size		Dimension (mm)			Ref. No.
Inch	DN	mm	L	H	
2"	50	60.3	178	254	G103060
2-1/2"	65	73	190	275	G103073
3OD"	65	76.1	190	275	G103076
3"	80	88.9	203	301	G103089
4"	100	114.3	229	355	G103114
6.5OD"	150	165.1	267	448	G103165
6"	150	168.3	267	448	G103168
8"	200	219.1	292	548	G103219
10"	250	273	330	626	G103273
12"	300	323.8	356	722	G103324

300 PSI WWP Iron Body Gate Valves

Fire Protection Valve • Bolted Bonnet • Outside Screw and Yoke • Solid Wedge •
Pre-Grooved Stem for Supervisory Switch Mounting

300 PSI/21 Bar Non-Shock Cold Water

CONFORMS TO MSS SP-70 •
UL/ULC LISTED • FM APPROVED •
APPROVED BY THE NEW YORK CITY B.S.A. 143-69-SA

MATERIAL LIST

PART	SPECIFICATION
1. Stem	Brass ASTM B 16 Alloy C36000
2. Handwheel Nut	Cast Bronze B 584 Alloy C84400
3. Identification Plate	Aluminum
4. Yoke Bushing	Cast Bronze B 584 Alloy C84400
5. Handwheel	Cast Iron ASTM A 126 Class B
6. Bonnet Cap Nut	Steel ASTM A 307
7. Bonnet Cap	Ductile Iron ASTM A 536
8. Bonnet	Cast Iron ASTM A 126 Class B
9. Bonnet Cap Bolt	Steel ASTM A 307
10. Gland Follower Nut	Brass ASTM B 36
11. Gland Follower	Ductile Iron ASTM A 536
12. Packing Gland	Zinc Plated Powdered Iron ASTM B 310 or Cast Brass ASTM Alloy C36000
13. Packing	Non Asbestos
14. Gland Follower Bolt	Steel ASTM A 307
15. Backseat Bushing	Cast Bronze B 584 Alloy C84400
16. Body Nut	Steel ASTM A 307
17. Body Bolt	Steel ASTM A 307
18. Wedge Pin	Silicon Bronze B 140 Alloy C31600
19. Body	Cast Iron ASTM A 126 Class B
20. Seat Ring	Cast Bronze B 584 Alloy C84400
21. Wedge Face Rings	Cast Bronze B 584 Alloy C84400
22. Wedge	Cast Bronze B 584 Alloy C84400
23. Body Gasket	Non Asbestos
24. Stem Collar	Brass ASTM B 16 Alloy C36000

¹Sizes up to 8" inclusive made with yoke integral with bonnet.
^{10"} and ^{12"} sizes made with separate yoke bolted to bonnet.

²Sizes 2½" thru 6" are all bronze wedges.
Sizes 8" thru 12" made with cast iron wedge with bronze wedge face rings

TS: pre-grooved stem for supervisory switch mounting.

DIMENSIONS—WEIGHTS—QUANTITIES

Size	Dimensions										Weight		
	A		B		C		D		E		Lbs.	Kg.	
In. mm.	In.	mm.	In.	mm.	In.	mm.	In.	mm.	In.	mm.			
2½	65	7.50	191	16.88	429	8.00	203	7.00	178	.69	17	55	25
3	80	8.00	203	19.75	502	8.00	203	7.50	191	.75	19	66	30
4	100	9.00	229	24.00	610	10.00	254	9.00	229	.94	24	107	49
5	125	10.00	254	27.50	699	10.00	254	10.00	254	.94	24	145	66
6	150	10.50	267	31.50	800	12.00	305	11.00	279	1.00	25	179	81
8	200	11.50	292	40.75	1035	14.00	356	13.50	343	1.13	29	308	140
10	250	13.00	330	48.50	1232	16.00	406	16.00	406	1.19	30	481	219
12	300	14.00	356	57.00	1448	18.00	457	19.00	483	1.25	32	706	321



F-607-OTS
Flanged

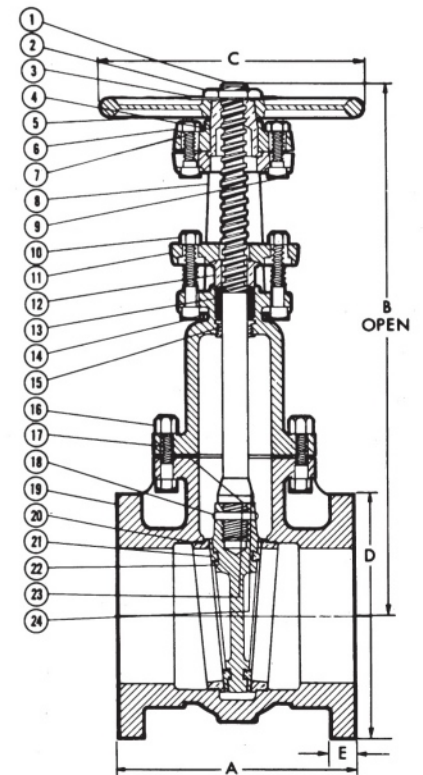

F-607-OTS
Flg x Flg

FREEZING WEATHER PRECAUTION: Subsequent to testing a piping system, gate valve should be in an open position to allow complete drainage.



300 PSI WWP Iron Body Check Valves

Fire Protection Valve • Bolted Bonnet • Horizontal Swing • Renewable Seat and Disc •
 Drilled and Tapped for Ball Drip Outlet

300 PSI/21 Bar Non-Shock Cold Water

CONFORMS TO MSS SP-71 •
 UL/ULC LISTED • FM APPROVED •
 APPROVED BY THE NEW YORK CITY B.S.A. 143-69-SA

MATERIAL LIST

PART	SPECIFICATION
1. Pipe Plug	Cast Iron or Steel
2. Bonnet	Cast Iron ASTM A 126 Class B
3. Bonnet Gasket	Non Asbestos
4. Bonnet Bolt and Nut	Steel ASTM A 307
5. Hinge Plug	Cast Bronze B 584 Alloy C84400
6. Hinge Pin	Brass ASTM B 16 (not shown)
7. Disc Hanger Nut	Cast Bronze B 584 Alloy C84400
8. Disc Stud Bolt	Brass ASTM B 16 Alloy C36000
9. Disc Cage	Cast Iron ASTM A 126 Class B or Malleable Iron ASTM A 47 (not shown)
10. Disc Plate	Cast Bronze B 584 Alloy C84400
11. Disc Hanger	Cast Bronze B 584 Alloy C84400
12. Disc Nut	Brass ASTM B 16 Alloy C36000
13. Seat Ring	Cast Bronze B 584 Alloy C84400
14. Disc	Rubber (W)
15. Body	Cast Iron ASTM A 126 Class B



F-908-W
Flanged

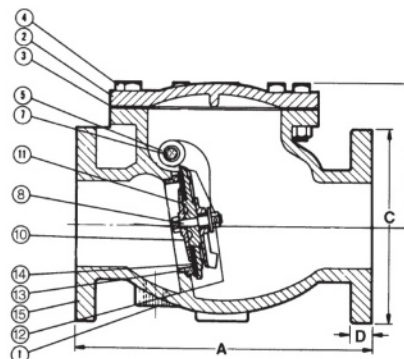

F-908-W
Flg x Flg

DIMENSIONS—WEIGHTS—QUANTITIES

Size	Dimensions								Weight	
	A		B		C		D		Lbs.	Kg.
In. mm.	In.	mm.	In.	mm.	In.	mm.	In.	mm.		
2½ 65	10.00	254	6.44	164	7.00	178	.69	17	53	24
3 80	10.25	260	6.63	168	7.50	191	.75	19	62	28
4 100	13.00	330	8.00	203	9.00	229	.94	24	103	47
5 125	15.00	381	9.19	233	10.00	254	1.00	25	145	66
6 150	16.25	413	10.31	262	11.00	279	1.00	25	174	79
8 200	19.50	495	11.50	292	13.50	343	1.13	29	290	132
10 250	22.00	559	13.31	338	16.00	406	1.19	30	490	223
12 300	27.50	699	15.56	395	19.00	483	1.25	32	683	310

NIBCO Iron Body check valves may be installed in both horizontal and vertical lines with upward flow.



Ball Drip



FULL BORE BALL VALVE(2 pieces)



PN16
DN 25 ... DN 300

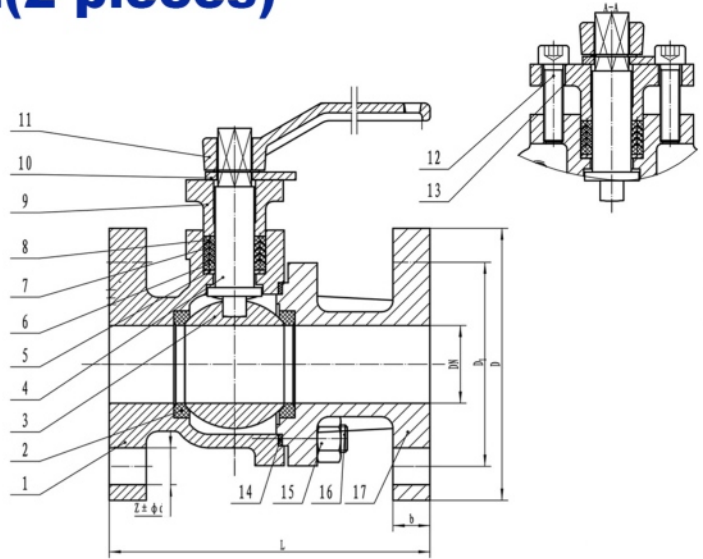

18	SCREW	35
17	RIGHT BODY	HT200
16	DOUBLE SCREW A	35
15	NUT	25
14	GASKET	PTFE
13	BEAD FLANGE A	65Mn
12	SCREW	35
11	HANDLE	QT450-10
10	STOP BLOCK	Q235
9	PACKING GLAND	QT450-10
8	PACKING	PTFE
7	PACKING	PTFE
6	PACKING	PTFE
5	PACKING SEAT	Q235
4	STEM	2Cr13
3	BALL	201
2	BALL SEAT	PTFE
1	LEFT BODY	HT200

DN / 项次	L	D	D ₁	b	Z-φd	D ₂
25	125	115	85	16	4-φ14	65
40	165	150	110	18	4-φ19	..
50	180	165	125	20	4-φ19	..
65	190	185	145	20	4-φ19	...
80	200	200	160	22	8-φ19	...
100	230	220	180	24	8-φ19	...
125	300	250	210	26	8-φ19	...
150	340	285	240	26	8-φ23	...
200	450	340	295	30	12-φ23	...

Grooved butterfly valve (Gear actuator & tamper switch)



- Certificate: UL Listed
- Standard: UL 1091 / MSS SP-67
- Connection: Grooved as AWWA C606
- Top flange: ISO 5211
- Indicator: Flag type position indicator
- Test: Factory hydro test 450 psi
- Temperature: 0°C to 100°C
- W. pressure: 300 psi
- Surface: Epoxy coating as Ral3000

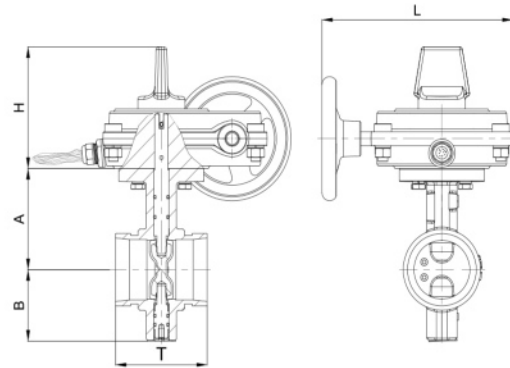

Main parts and material

Body	Ductile iron as A536, 65-45-12	Shaft	SS431
Disc	Ductile iron + EPDM / NBR	Signal gearbox	Housing / cover: ductile iron
Worm	Carbon steel or Ductile iron	Handwheel	Ductile iron as A536, 65-45-12

Available size

Size			Dimension (mm)					Ref. No.
Inch	DN	mm	A	B	H	L	T	
2"	50	60.3	89	65	123	202	81	G101060
2-1/2"	65	73.0	102	71	123	202	97	G101073
3OD	65	76.1	102	71	123	202	97	G101076
3"	80	88.9	109	81	123	202	97	G101089
4"	100	114.3	128	95	123	202	116	G101114
6.5OD	150	165.1	153	133	123	202	148	G101165
6"	150	168.3	153	133	123	202	148	G101168
8"	200	216.7	184	164	123	260	153	G10127G
8"	200	219.1	184	164	123	260	153	G101219

Flanged swing check valve



- Certificate: Pending
- Standard: UL 312 / AWWA C508
- Connection: Flanged as ASME B16.1
- Test: Factory hydro test 450 psi
- Temperature: 0°C to 100°C
- W. pressure: 300 psi
- Surface: Epoxy coating as Ral3000

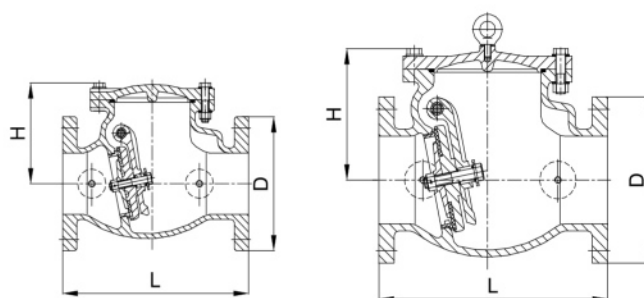

Main parts and material

Body	Ductile iron as A536, 65-45-12	Bonnet	Ductile iron as A536, 65-45-12
Disc	Ductile iron as A536, 65-45-12 + EPDM	Seat ring	Bronze as ASTM B62 C83600 / AISI304
Hinge pin	AISI 304	Clapper arm	Ductile iron as A536, 65-45-12

Available size

Size			Dimension (mm)			Bolting (n x φd)	Ref. No.
Inch	DN	mm	L	H	D		
2"	50	60.3	203	133	152	4 x 3/4"	C503050
2-1/2"	65	73.0	254	150	178	4 x 3/4"	C503065
3"	80	88.9	278	150	191	4 x 3/4"	C503080
4"	100	114.3	330	218	229	8 x 3/4"	C503100
6"	150	168.3	406	290	279	8 x 7/8"	C503150
8"	200	219.1	495	330	343	8 x 7/8"	C503200
10"	250	273.0	622	350	406	12 x 1"	C503250
12"	300	323.8	660	376	483	12 x 1"	C503300

Flanged swing check valve



- Certificate: Pending
- Standard: EN 1074-3
- Connection: Flanged as BS EN 1092-2
- Test: Factory hydro test 24 bar
- Temperature: 0°C to 100°C
- W. pressure: PN 16/300Psi
- Surface: Epoxy coating as Ral3000

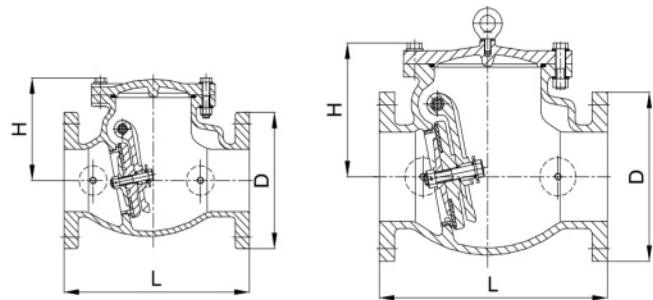

Main parts and material

Body	Ductile iron as EN-GJS-450-10	Bonnet	Ductile iron as EN-GJS-450-10
Disc	Ductile iron as EN-GJS-450-10 + EPDM	Seat ring	Bronze as ASTM B62 C83600 / SS304
Hinge pin	SS304 / SS316	Clapper arm	Ductile iron as EN-GJS-450-10

Available size

Size			Dimension (mm)			Bolting (n x φd)	Ref. No.
Inch	DN	mm	L	H	D		
2"	50	60.3	203	133	165	4 x 3/4"	F303050
2-1/2"	65	76.1	216	150	185	4 x 3/4"	F303065
3"	80	88.9	241	150	200	4 x 3/4"	F303080
4"	100	114.3	292	218	220	8 x 3/4"	F303100
6"	150	168.3	356	290	285	8 x 7/8"	F303150
8"	200	219.1	495	330	340	8 x 7/8"	F303200
10"	250	273.0	622	350	405	12 x 1"	F303250
12"	300	323.9	698	376	460	12 x 1"	F303300

Grooved swing check valve



- Certificate: Pending
- Standard: UL 312 / AWWA C508
- Connection: Grooved as AWWA C606
- Test: Factory hydro test 450 psi
- Temperature: 0°C to 100°C
- W. pressure: 300 psi
- Surface: Epoxy coating as Ra13000

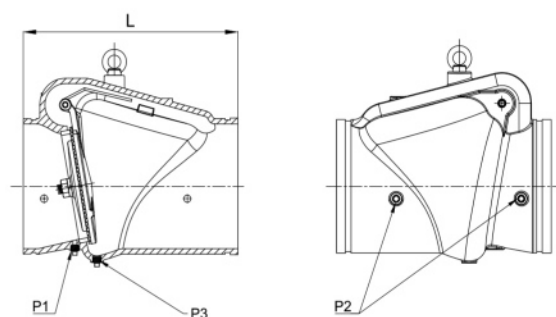

Main parts and material

Body	Ductile iron as A536, 65-45-12	Hinge pin	AISI 420
Disc	SS304 + EPDM (2" to 4")	Disc	Ductile iron as A536, 65-45-12 + EPDM (5" to 12")
Seat ring	Bronze as ASTM B62 C83600 / SS304	Plug	Galvanized malleable iron / bronze

Available size

Inch	Size		Length L (mm)	P1	P2	P3	Ref. No.
	DN	mm					
2"	50	60.3	171	1/2"	3/8"	1/2"	G102060
2-1/2"	65	73	184	1/2"	3/8"	1/2"	G102073
3OD	65	76.1	184	1/2"	3/8"	1/2"	G102076
3"	80	88.9	197	1/2"	3/8"	1/2"	G102089
4"	100	114.3	210	1/2"	1/2"	1/2"	G102114
6"	150	165.1	324	1/2"	1/2"	1/2"	G102165
6"	150	168.3	324	1/2"	1/2"	1/2"	G102168
	200	216.7	371	1/2"	1/2"	1/2"	G102217
8"	200	219.1	371	1/2"	1/2"	1/2"	G102219

Flanged Y type strainer



- Certificate: Pending
- Standard: UL Subject 321
- Connection: Flanged as ANSI B16.1
- Test: Factory hydro test 450 psi
- Temperature: 0°C to 100°C
- W. pressure: 300 psi
- Surface: Epoxy coating as Ra13000

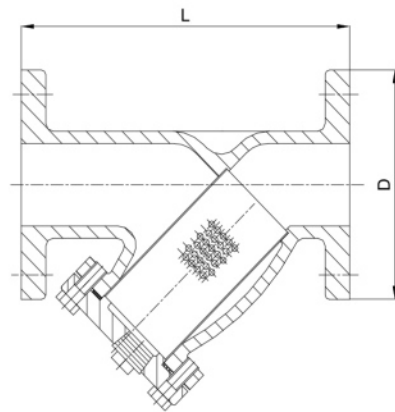

Main parts and material

Body	Ductile iron as A536, 65-45-12	Bonnet	Ductile iron as A536, 65-45-12
Screen	SS304 / SS316 (Perforated)	Plug	Malleable iron / bronze

Available size

Size			Dimension (mm)		Screen		Bolting (n x φd)	Ref. No.
Inch	DN	mm	L	D	Hole Dia. (mm)	Free flow area		
2"	50	60.3	230	152	4	48%	4 x 3/4"	C505060
2-1/2"	65	73.0	290	178	4	48%	4 x 3/4"	C505065
3"	80	88.9	310	191	5	59%	4 x 3/4"	C505080
4"	100	114.3	350	229	5	59%	8 x 3/4"	C505100
5"	125	141.3	400	254	6	63%	8 x 7/8"	C505125
6"	150	168.3	480	279	6.3	64%	8 x 7/8"	C505150
8"	200	219.1	600	343	6.3	64%	8 x 7/8"	C505200
10"	250	273.0	730	406	6.3	64%	12 x 1"	C505250
12"	300	323.8	850	483	6.3	64%	12 x 1"	C505300

Flanged Y type strainer



- Certificate: Pending
- Standard: UL Subject 321
- Connection: Flanged as EN 1092-2
- Test: Factory hydro test 24 bar
- Temperature: 0°C to 100°C
- W. pressure: PN16/300Psi
- Surface: Epoxy coating as Ral3000

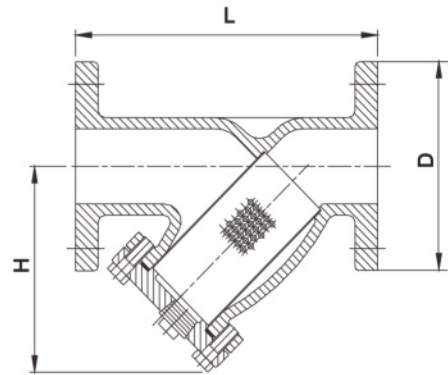

Main parts and material

Body	Ductile iron as EN-GJS-450-10	Bonnet	Ductile iron as EN-GJS-450-10
Screen	SS304 / SS316 (Perforated)	Plug	Malleable iron / bronze

Available size

Size			Dimension (mm)		Screen		Bolting (n x φd)	Ref. No.
Inch	DN	mm	L	D	Hole Dia. (mm)	Free flow area		
2"	50	60.3	230	165	4	48%	4 x φ19	F305060
2-1/2"	65	73.0	290	185	4	48%	4 x φ19	F305065
3"	80	88.9	310	200	5	59%	8 x φ19	F305080
4"	100	114.3	350	220	5	59%	8 x φ19	F305100
5"	125	141.3	400	250	6	63%	8 x φ19	F305125
6"	150	168.3	480	285	6.3	64%	8 x φ23	F305150
8"	200	219.1	600	340	6.3	64%	12 x φ23	F305200
10"	250	273.0	730	405	6.3	64%	12 x φ28	F305250
12"	300	323.8	850	460	6.3	64%	12 x φ28	F305300

Grooved Y type strainer



- Certificate: Pending
- Standard: UL Subject 321
- Connection: Grooved as ISO 6182
- Test: Factory hydro test 24 bar
- Temperature: 0°C to 100°C
- W. pressure: 300Psi
- Surface: Epoxy coating as Ral3000

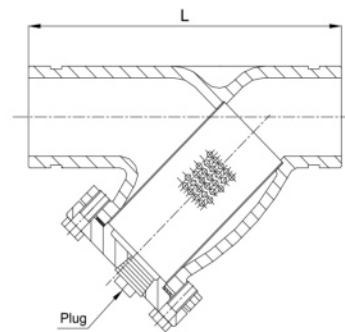

Main parts and material

Body	Ductile iron as EN-GJS-450-10	Cap	Ductile iron as EN-GJS-450-10
Screen	SS304 / SS316 (Perforated)	Plug	Malleable iron / bronze

Available size

Size		Length		Screen	Free flow area	Ref. No.
Inch	DN	mm	L (mm)	Hole Dia. (mm)		
2"	50	60.3	230	4	48%	G105060
2-1/2"	65	73	290	4	48%	G105073
3OD	65	76.1	290	4	48%	G105076
3"	80	88.9	310	5	59%	G105080
4"	100	114.3	350	5	59%	G105114
6.5OD"	150	165.1	470	6.3	64%	G105165
6"	150	168.3	480	6.3	64%	G105168
	200	216.7	550	6.3	64%	G105217
8"	200	219.1	550	6.3	64%	G105219

Waterflow indicator

The vane-type waterflow indicator (waterflow detector) is used to detect a sustained flow and give signal on wet-pipe sprinkler systems. It includes mechanical time delay feature to reduce the risk of false alarm.



Threaded type (T)



U-bolt type (U)

- Certificate: Pending
- Standard: ANSI / UL 346
- Sensitivity: Flow rate 4-10 US GPM
- Contact ratings: 8A at 125/250 VAC, 3A at 24VDC, 2.5A at 30VDC
- Maximum surge: 18 feet per second (FPS)
- Temperature: 0°C to 68°C
- W. pressure: 450 psi
- Surface: FBE coating as AWWA C550

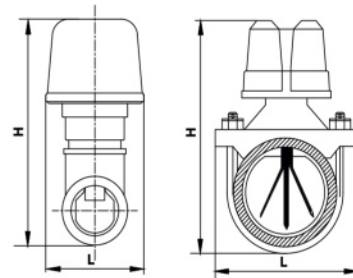

Main parts and material

Cover	Plastic / AL alloy	Vane / paddle	Plastic
Threaded saddle	Copper alloy	U-bolt saddle	AL alloy / ductile iron

Available size of threaded & U-bolt type

Size			Dimension (mm)		Ref. No.
Inch	DN	mm	L	H	
2"	50	60.3	93	192	W600060
2-1/2"	65	73.0	92	200	W600073
	65	76.1	92	200	W600076
3"	80	88.9	104	220	W600089
4"	100	114.3	133	245	W600114
	150	165.1	187	300	W600165
6"	150	168.3	187	300	W600168
	200	219.1	239	350	W600219

Test and drain valve

Test and drain valve provides both the test and the drainage function on wet-pipe sprinkler systems. It is lightweight and compact, containing a single handle ball valve with test orifice and sight glasses.



- Certificate: Pending
- Standard: UL Subject 258
- Connection: Female thread, NPT or BSPT / grooved
- Hydro test: 350 psi
- Temperature: 0°C to 100°C
- W. pressure: 175 psi
- Surface: Rough brass

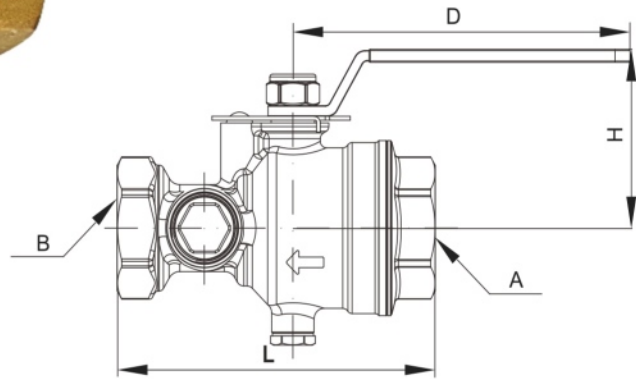

Main parts and material

Body	Brass as B584 C85700	Stem	Brass as B584 C85700
Ball	Brass as B584 C85700, chrome plated	Seal	Teflon (PTFE)
Handle	Carbon steel	Handle stop	Carbon steel

Available size of threaded & grooved type

Size			Dimension (mm)			Inlet / outlet	Ref. No.
Inch	DN	mm	L	H	D	A / B	
1"	25	33.4	115	67	148.3	Threaded	T600025
1-1/4"	32	42.2	123	71	148.3	Threaded	T600032
1-1/2"	40	48.3	136	75	173.5	Threaded	T600040
2"	50	60.3	153	79	173.5	Threaded	T600050

Vertical indicator post / wall indicator post

Vertical indicator post is used to operate a buried or inaccessible valve, and wall indicator post operates a valve behind the wall. It also indicates the OPEN or SHUT status of the valve through the viewing window.



V800 (Vertical)



W800 (Wall)

- Certificate: Pending
- Body: Cast iron as ASTM A126, B
- Window: Plexiglass
- Handle: DI as ASTM A536, 65-45-12
- Surface: FBE coating as AWWA C550

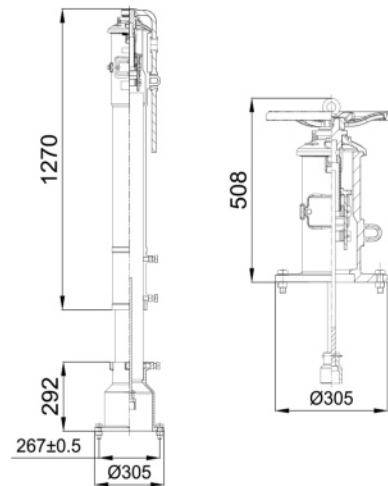

Hydrant key socket

Hydrant key socket is designed to operate a buried hydrant, or buried & inaccessible NRS valve.

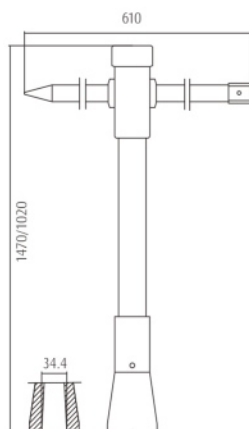

- Certificate: ISO
- Standard: BS 5163
- Connection: To fit post top of valve
- Ref. No.: V21

Material list

Body	Aluminum Alloy as A356
Upper spring	SS304
Inner bar	Aluminum Alloy as 6061
Connection	Aluminum Alloy as A356

Dry barrel hydrant

Dry barrel hydrant is normally used in cold region and the barrel of the hydrant is dry when not in use.



- Certificate: No
- Standard: AWWA C502
- Inlet shoe: 6" mechanical joint as AWWA C111
6" flange as ANSI B16.1, class 125
- Buried depth: 915mm ~ 1981mm
- Test: Factory hydro test 500 psi
- W. pressure: 250 psi
- Temperature: -10°C to 82°C
- Surface: FBE coating as AWWA C550

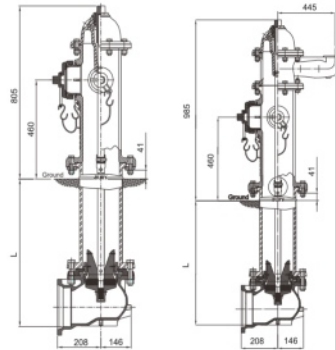

Main parts and material

Upper / lower barrel	Ductile iron as A536, 65-45-12	Bonnet	Cast iron as ASTM A126 Class B
Hose nozzle	Bronze as ASTM B62	Pumper nozzle	Bronze as ASTM B62

Available size

Ways	Outlet		Monitor elbow	Model
	Hose outlet	Pumper outlet		
2	2.5" NH x 2	Non	Non	F09-2
2	2.5" NH x 2	Non	3" or 4" x 1	F09-2M
4	2.5" NH x 4	Non	Non	F09-4
4	2.5" NH x 4	Non	3" or 4" x 1	F09-4M
3	2.5" NH x 2	4" or 4.5" NH x 1	Non	F09-2P
3	2.5" NH x 2	4" or 4.5" NH x 1	3" or 4" x 1	F09-2PM
4	2.5" NH x 3	4" or 4.5" NH x 1	Non	F09-3P
4	2.5" NH x 3	4" or 4.5" NH x 1	3" or 4" x 1	F09-3PM
4	2.5" NH x 2	4" or 4.5" NH x 2	Non	F09-2P2
4	2.5" NH x 2	4" or 4.5" NH x 2	3" or 4" x 1	F09-2P2M

QUICK RESPONSE AUTOMATIC SPRINKLERS

DESCRIPTION AND OPERATION

The Condor Quick Response Series Sprinklers are a low profile yet durable design which utilizes a 3mm frangible glass ampule as the thermosensitive element. This provides sprinkler operation approximately six times faster than ordinary sprinklers. While the Quick Response Sprinkler provides an aesthetically pleasing appearance, it can be installed wherever standard spray sprinklers are specified when allowed by the applicable standards. It offers the additional feature of greatly increased safety to life and is available in various styles, orifices, temperature ratings and finishes to meet many varying design requirements. Quick Response Sprinklers should be used advisedly and under the direction of approving authorities having jurisdiction.

The heart of Condor's GL Series sprinkler proven actuating assembly is a hermetically sealed frangible glass ampule that contains a precisely measured amount of fluid. When heat is absorbed, the liquid within the bulb expands increasing the internal pressure. At the prescribed temperature the internal pressure within the ampule exceeds the strength of the glass causing the glass to shatter. This results in water discharge which is distributed in an approved pattern depending upon the deflector style used.

The sprinkler and escutcheon are not factory assembled. Assembly is done in the field.

TECHNICAL DATA

- See reverse side for Approvals and Specifications.
- Temperature Ratings - 135°F (57°C), 155°F (68°C), 175°F (79°C), 200°F (93°C), 286°F (141°C)
- Water Working Pressure Rating - 175 psi (12 Bars)
- Factory tested hydrostatically to 500 psi (34 Bars)
- Maximum low temperature glass bulb rating is -67°F (-55°C)
- Frame - bronze • Deflector - brass • Screw - brass
- Bulb seat - copper • Spring - nickel alloy • Seal - teflon
- Bulb - glass with alcohol based solution, 3mm size

• SPRINKLER TEMPERATURE RATING/CLASSIFICATION and COLOR CODING

CLASSIFICATION	AVAILABLE SPRINKLER TEMPERATURES		BULB COLOR	N.F.P.A. MAXIMUM CEILING TEMPERATURE	
ORDINARY	135°F/155°F	57°C/68°C	ORANGE/RED	100°F	38°C
INTERMEDIATE	175°F/200°F	79°C/93°C	YELLOW/GREEN	150°F	66°C
HIGH	286°F	141°C	BLUE	225°F	107°C

UPRIGHT • PENDENT RECESSED PENDENT



UPRIGHT



PENDENT



RECESSED PENDENT

**QUICK RESPONSE
AUTOMATIC SPRINKLERS**

**UPRIGHT • PENDENT
RECESSED PENDENT**

SPECIFICATIONS

NOMINAL "K" FACTOR		THREAD SIZE	LENGTH ¹	FINISHES
2.8	(39 metric)	1/2" NPT	2 1/4" (5.7 cm)	Factory Bronze
4.2	(59 metric)	1/2" NPT	2 1/4" (5.7 cm)	Satin Chrome ²
5.6	(80 metric)	1/2" NPT	2 1/4" (5.7 cm)	Bright Chrome
7.8	(111 metric)	1/2" NPT	2 1/4" (5.7 cm)	White Polyester ³
8.1	(116 metric)	3/4" NPT	2 7/16" (6.2 cm)	Black Polyester ³
				Lead Coated ²

NOTE: METRIC CONVERSIONS ARE APPROXIMATE.

¹ HORIZONTAL SIDEWALL IS 2 9/16".

² FINISHES AVAILABLE ON SPECIAL ORDER.

³ AVAILABLE AS cULus LISTED CORROSION RESISTANT WHEN SPECIFIED ON ORDER.

APPROVALS

STYLE	SIN MODEL	K FACTOR	135°F 57°C	155°F 68°C	175°F 79°C	200°F 93°C	286°F 141°C	cULus	F.M.	LPC	CE	NYC - DOB MEA 101-92-E
UPRIGHT	GL2815	2.8	X	X	X	X	X	X	--	--	--	X
	GL4215	4.2	X	X	X	X	X	X	--	--	--	X
	GL5615	5.6	X	X	X	X	X	X	X	X	X	X
	GL8115	7.8*	X	X	X	X	X	X	X	--	--	X
	GL8118	8.1	X	X	X	X	X	X	X	X	X	X
PENDENT	GL2801	2.8	X	X	X	X	X	X	--	--	--	X
	GL4201	4.2	X	X	X	X	X	X	--	--	--	X
	GL5601	5.6	X	X	X	X	X	X	X	X	X	X
	GL8101	7.8*	X	X	X	X	X	X	X	--	--	X
	GL8106	8.1	X	X	X	X	X	X	X	X	X	X
RECESSED PENDENT	GL5632	5.6	X	X	X	X	X	X	X	--	--	--
	GL8133	8.1	X	X	X	X	X	X	--	--	--	--



UPRIGHT



PENDENT



RECESSED PENDENT

AIR VENT VALVE

Automatic exhaust valves are used in independent heating systems, central heating systems, heating boilers, central air conditioning, floor heating and solar heating systems and other pipe exhaust. Because water usually dissolves a certain amount of air, and the solubility of air decreases with the temperature. In this process of water circulation gas gradually separated from the water, and gradually gathered together to form large bubbles and even columns, the role of the exhaust valve is to release gas, to ensure that the system pressure is not too high, causing danger.

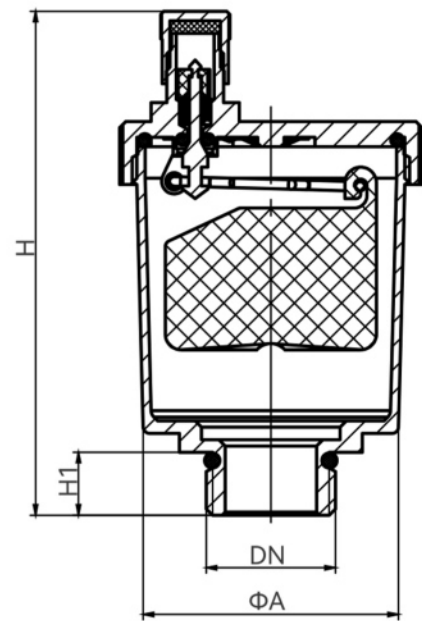

DN	ΦA(mm)	H(mm)	H1(mm)
NPT1/8"	40	80	10
G3/8"	40	80	10
G1/2"	40	80	10
G3/4"	40	82	12
G1"	40	85.5	15.5

Product Description

Material: brass

Applicable medium: water

Drive mode: hydraulic control

Connection mode: external thread

Operating temperature: normal temperature

Flow direction: bidirectional

Maximum working pressure: 10bar

Maximum temperature (water): 110 °C

Exhaust pressure: 3 bar

Special function: exhaust without drainage

BRSS FILTER VALVE

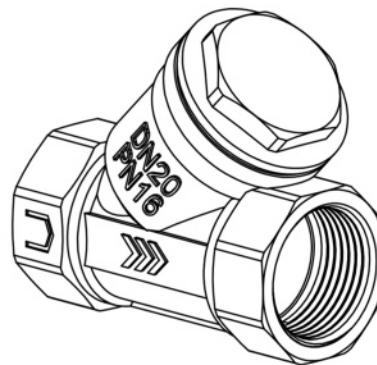
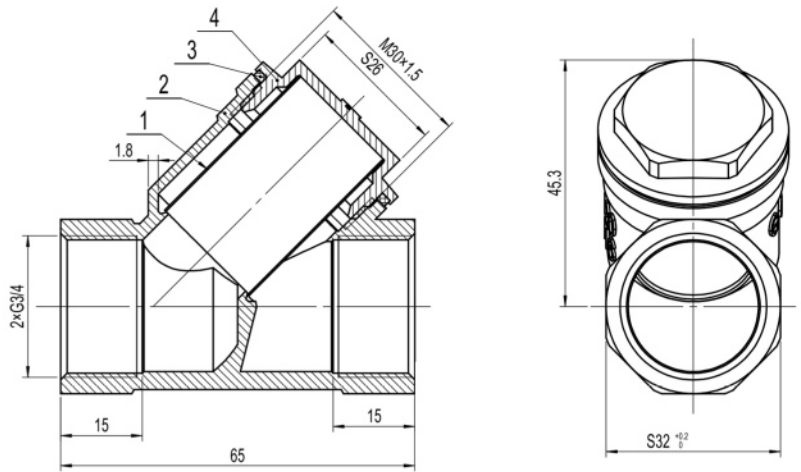

4	GL1001.20-13	BONNET	1	HPb59-1	32
3	Ø30×1.5 (外径Ø34)	GASKET	1	PTFE	0.1
2	GL1001.20-03	BODY	1	HPb59-1	167
1	GL1001.20-23	MESH	1	304	2.2

Features

Working pressure 16 bar (232 psi)

Working temperature from -10°C to +120°C (from 14 °F to 248 °F)

Thread ISO228 (equivalent to DIN 259 and BS2779)

Size	1/2"	3/4"	1"	1 1/4"	1 1/2"	2"	2 1/2"	3"	4"
-------------	------	------	----	--------	--------	----	--------	----	----

BRASS BALL VALVE

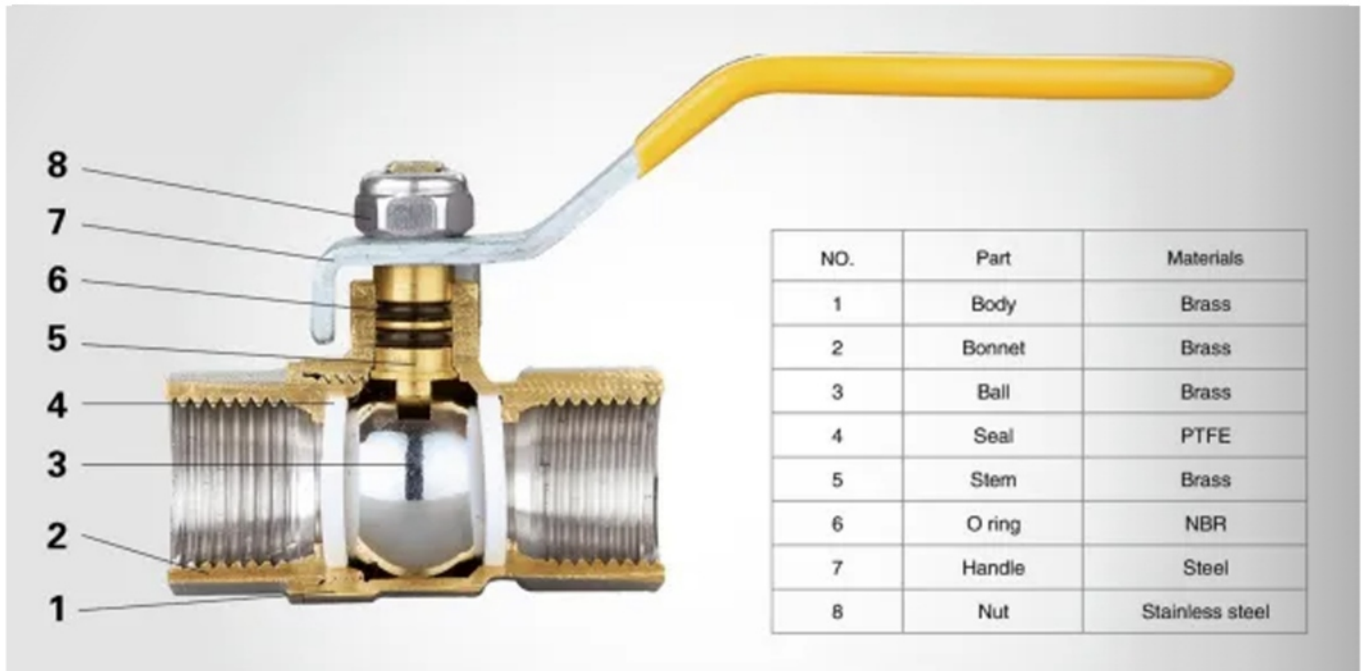
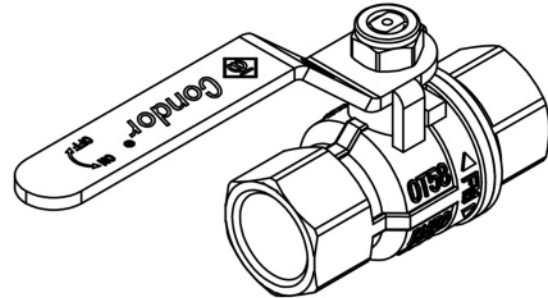

Features

Working pressure 25 bar (362.5 psi)

Working temperature from -10°C to $+120^{\circ}\text{C}$ (from 14°F to 248°F)

Thread ISO228 (equivalent to DIN 259 and BS2779)

Opening/closing test 10000 times

Reminding: Ball valves in yellow handle can be only used in all types of gas , town gas (1st family), natural gas (2nd family),and liquid gas (3rd family). They are not allowed to be used in any water and air systems.

BRASS BALL VALVE

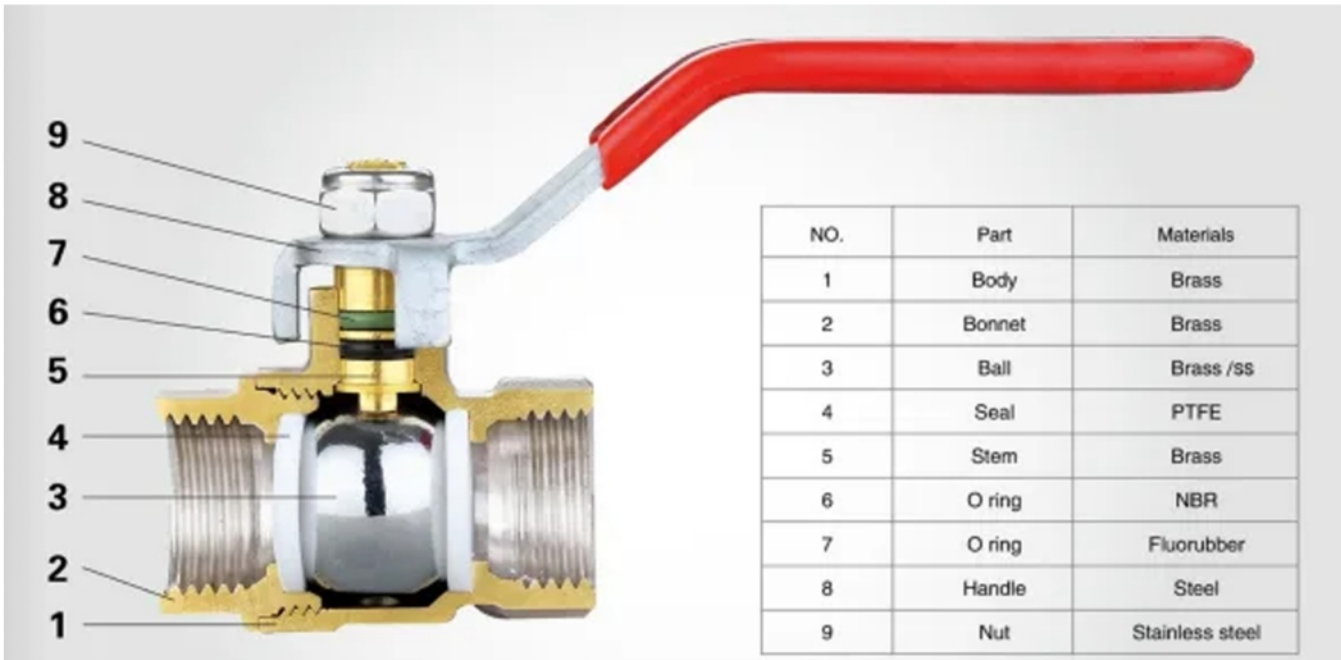
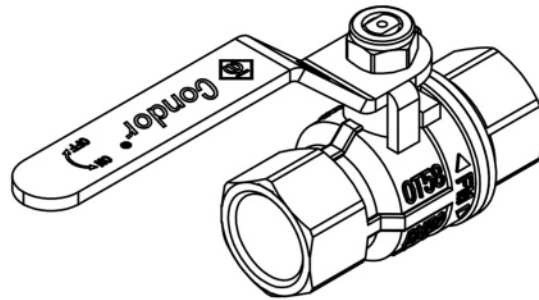

NO.	Part	Materials
1	Body	Brass
2	Bonnet	Brass
3	Ball	Brass /ss
4	Seal	PTFE
5	Stem	Brass
6	O ring	NBR
7	O ring	Fluorubber
8	Handle	Steel
9	Nut	Stainless steel

Features

Working pressure 25 bar (362.5 psi)

Working temperature from -10°C to +120°C (from 14 °F to 248 °F)

Thread ANSI

Opening/closing test 10000 times

Reminding : Ball valves in red handle can be only used in water services, heating and air conditioning plants, and compression air systems. They are not allowed to be used in gas system.

BRASS GATE VALVE

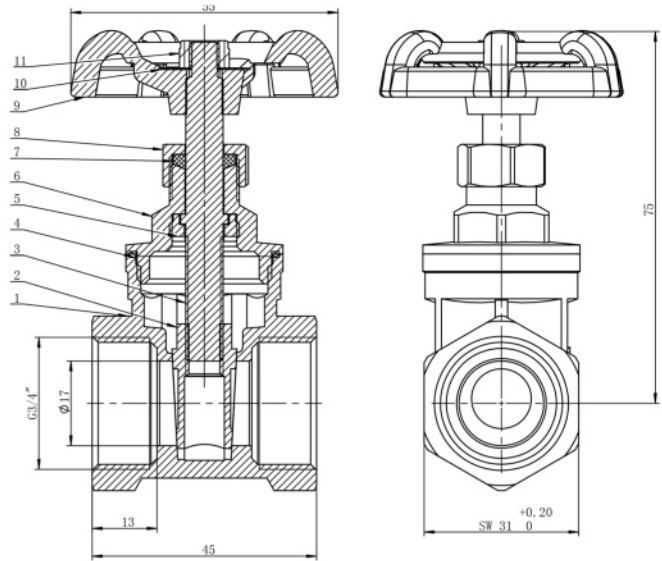

NO.	Part	Materials
1	Body	Brass
2	Gate	Brass
3	Filler	PTFE
4	Bonnet	Brass
5	Lock Cap	Brass
6	Stem	Brass
7	Handwheel	Cast-iron
8	Nut	Stainless steel

Features

Working pressure 16 bar (232 psi)

Working temperature from -10°C to +120°C (from 14 °F to 248 °F)

Thread ISO228 (equivalent to DIN 259 and BS2779)

Size	1/2"	3/4"	1"	1"1/4	1"1/2	2"	2"1/2	3"	4"
-------------	------	------	----	-------	-------	----	-------	----	----

LIQUID FILLED PRESSURE GAUGE

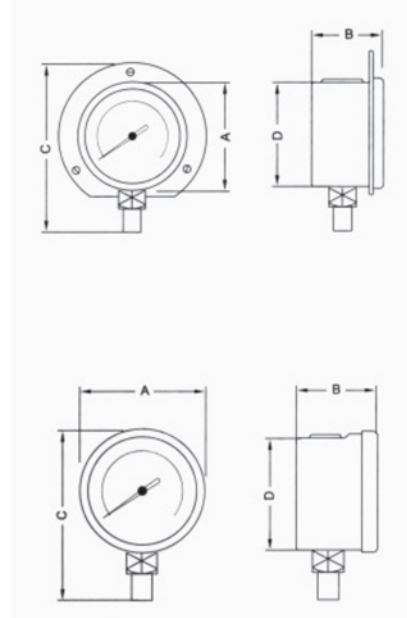

Description:

Diameter: 6" , 4" , 3" , 2 1/2" , 2" , 1 1/2" ,

Case: plastic, steel, stainless steel

Window: Polycarbonate

Movement: brass, stainless steel

Connection: bottom

Connection: 1/2" , 1/4" , 1/8" , 3/8" , BSP, NPT, PT

Accuracy: 3" --6" 1.5-1.0% 1 1/2" --2 1/2" : 2.5--1.6%

Diameter	A	B	C	D	T.Ambient
6"	160	48.3	190	148	20°C-60°C
4"	110	37	136.6	100	
3"	81	32.7	113	74.6	
2 1/2"	67.9	28.2	90.8	62	
2"	57.3	28.6	79.2	52	
1 1/2"	46.8	25	66.3	41	

FLEXIBLE METAL HOSE



Material Specifications	
Bellows	SUS304
Connections	Copper

Operating Conditions	
Operating Pressure	≤ 1.6 MPa
Operating Temperature	-20°C ~ 150°C
Length	30-80CM

Diameter	Inner Diameter mm	BSPT
		DN20
DN25	25.4	1"

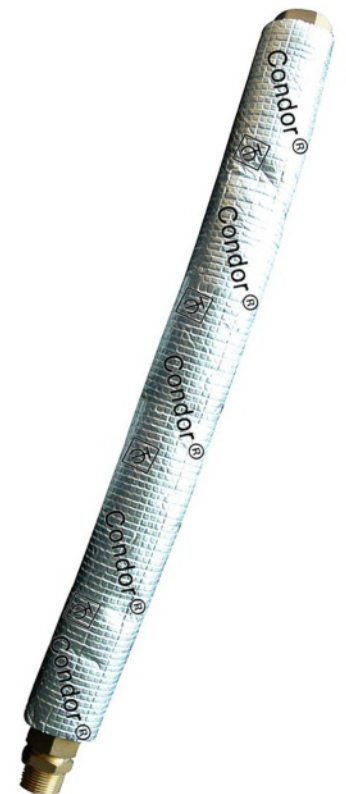

HEXAGONAL CARBON STEEL BALL VALVE

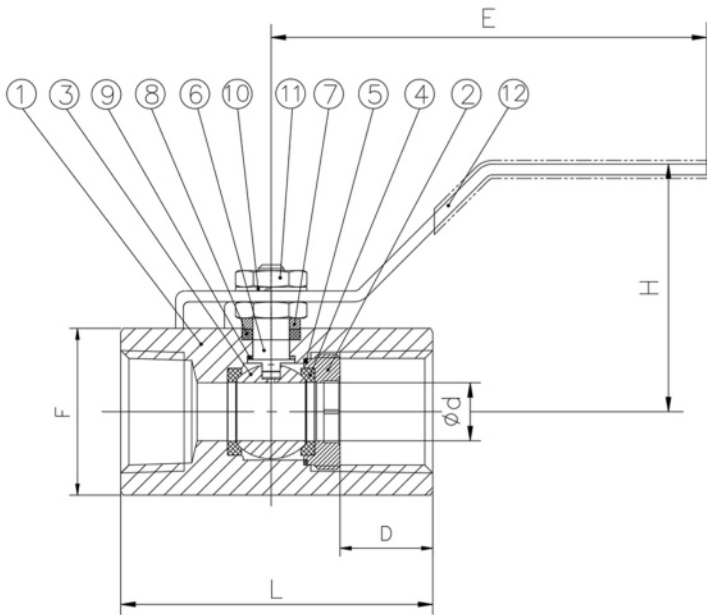
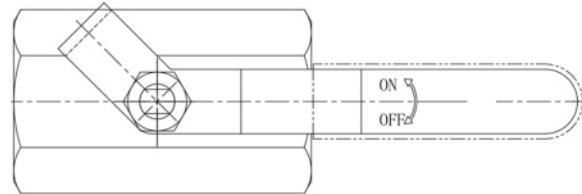

12	HANDLE	1	SS201	SS201	SS201
11	NUT	2	SS304	SS304	SS304
10	SPRING WASHER	1	SS304	SS304	SS304
9	THRUST WASHER	1	PTFE	PTFE	PTFE
8	PACKING	1	PTFE	PTFE	PTFE
7	GLAND	1	SS304	SS304	SS304
6	STEM	1	SS316	SS316	SS316
5	GASKET	1	PTFE	PTFE	PTFE
4	SEAT	2	PTFE	PTFE	PTFE
3	BALL	1	SS316	SS316	SS316
2	SEAT RETAINER	1	A105/A105N	LF2	SS316
1	BODY	1	A105/A105N	LF2	SS316
ITEM	DESCRIPTION	Q'TY	MATERIAL	MATERIAL	MATERIAL

NOTES: 1.WORKING PRESSURE:3000PSI;
 2.TESING PRESSURE;
 SEAT: 3000PSI(WATER) OR 80PSI(AIR)
 SHELL: 3000PSI(WATER) OR 80PSI(AIR)
 3.CONFORM TO NACE & ANSI B16.34;

- **Size** 1/4"~4"
- **Pressure** 3000PSI
- **Materials** A105, LF2
- **Applications** Oil&Gas,Petrochemical, Chemical

API607 Fire Safe Certificate Approved
 ASME B16.34, NACE MR0175

Condor[®]

Condor Industriel Inc.

Add: 2630 rue Lapierre, LaSalle, QC. Canada H8N 2W9

Tel: 001 514 9966086

Web: www.condorindustriel.ca

Mail: info@condorindustriel.ca